

Fig. 8

### Step 3: Hang the Display

With the help of an assistant, lift the display into position in front of the wall bracket. Align the slots on the rails with the mounting flanges on the wall bracket, and then carefully lower the display onto the mounting flanges. (Fig. 8)

**Make sure that both upper and lower mounting flanges are fully engaged before releasing the display.**

Once in place, the lateral position of the display can be adjusted by gently sliding it along the flanges.

### Step 4: Lock the Display

Using the supplied **Hex Pin Wrench**, install the **Locking Bar** across the top of the **Top Wall Bracket** with two **Hex Pin Screws**. (Fig. 9)

For additional security, small padlocks may be secured through slots on the Locking Bracket and Wall bracket.

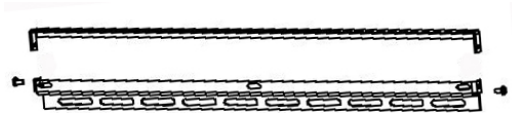

Fig. 9

## Installation Instructions

### Medium Universal Fixed Flat Panel Mount

Fits most 23" - 37" Displays



Universal Mount—No Adaptor Plate Needed

18 1/2" Wide Wall bracket

High Capacity/Low Profile Design

Lift n' Lock Installation

**IMPORTANT: Consult a qualified installer if you have any questions regarding the proper installation of this wall mount system.**

## Hardware Kits:

Kit 1: Mount Hardware		
ID	Qty	Description
	1	Hex Pin Wrench
	4	Lag Bolt: 5/16" x 2 1/2"
	4	Lag Bolt Washer
	4	Square Washer
Kit 2: Display Hardware		
ID	Qty	Description
A	4	Philips Screw M4 x 16mm
B	4	Philips Screw M4 x 36mm
C	4	Philips Screw M4 x 45mm
D	4	Philips Screw M5 x 16mm
E	4	Philips Screw M5 x 35mm
F	4	Philips Screw M5 x 45mm
G	4	Philips Screw M6 x 16mm
H	4	Philips Screw M6 x 35mm
I	4	Philips Screw M6 x 46mm
J	4	Philips Screw M8 x 16mm
K	4	Philips Screw M8 x 35mm
L	4	Philips Screw M8 x 45mm
M	4	5/8" Spacer
N	4	3/4" Spacer

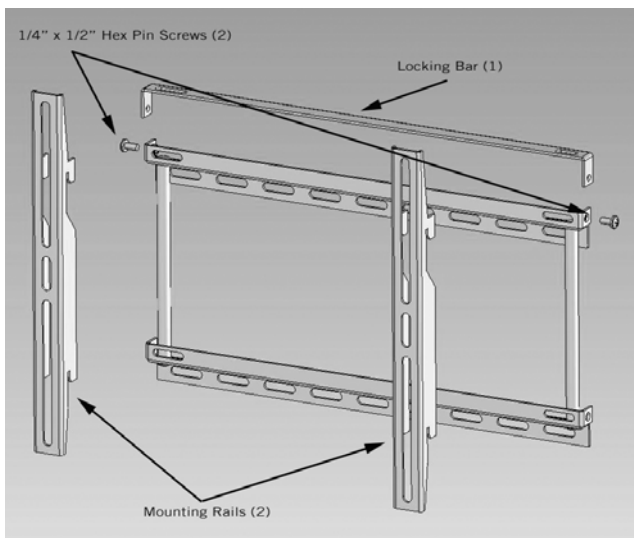

### Step 1: Mount the Wall Bracket

Determine the desired location for the display.

**Important:** Make sure there is adequate mounting space available for the display, considering the display dimensions.

**Wooden Stud Mounting:** Using an electronic stud finder, locate the center of the wooden studs. Position the wall bracket in desired mounting location over studs.

**Note:** Top side of wall bracket is labeled "Top" on the inside of channel for easy identification.

Level the wall bracket with a bubble level, and then using the wall bracket as a template, mark mounting hole locations over the studs.

Drill 4 mounting holes into the center of the studs using 1/4" drill bit.

Mount wall bracket to the studs with supplied 3/8" lag bolts and washers.

**Masonry Mounting:** Note: Masonry mounting requires the use of wall anchors, which are not supplied.

Position the wall bracket in desired mounting location on wall.

**Note:** Top side of wall bracket is labeled "Top" on the inside of channel for easy identification.

Level the wall bracket with a bubble level, and then using the wall bracket as a template, mark mounting hole locations on wall.

Drill 4 mounting holes using a masonry bit of the correct diameter for your wall anchors. Insert wall anchors into the mounting holes, and lightly tap them flush to the wall with a hammer. Mount the wall bracket to the wall with supplied 3/8" lag bolts and washers.

**Caution:** Wall anchors should only be used for masonry mounting. **NEVER** use wall anchors to attach the mount to drywall.

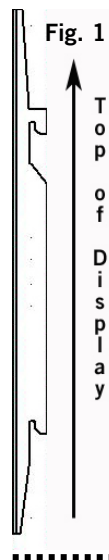

Fig. 1

### Step 2: Attach the Mounting Rails

For proper installation, the mounting rails should be orientated as shown in Fig. 1. Consult the supplied **Hardware Cross Reference** list, for the correct hardware to use with your display. Use the selected screws and the square washers to mount the rails to the back of the display. (Fig. 2)

Use the registration marks (Fig. 3) to align the rails to equal heights on the back of the display, and then tightly secure the mounting screws.

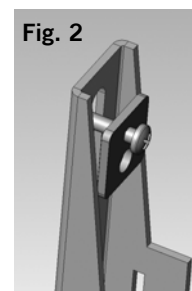

Fig. 2

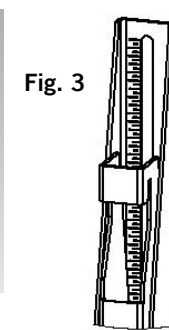

Fig. 3

### Using Spacers

The hardware kit includes a complete set of multipurpose **Spacers**. These **Spacers** can be used as required, to optimize the mount for use with any type of display. Please see below for details.

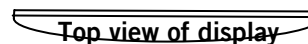

Fig. 4

Some Plasma displays have curved backs with recessed mounting lands. (Fig. 4)

For best fit on this type of display, install the 5/8" spacer (M) (Fig. 5) between the display and the mounting rail.

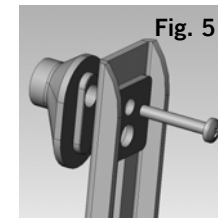

Fig. 5

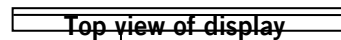

Fig. 6

For displays with protruding HDTV tuner packs or deeply curved backs (Fig. 6), larger spacers must be used.

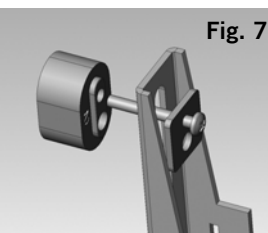
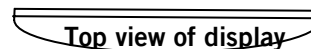

Fig. 7

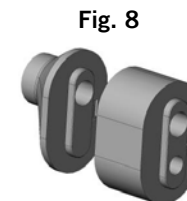

Fig. 8

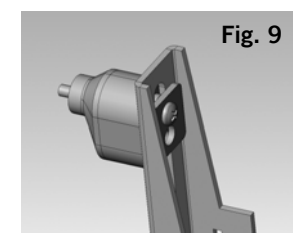

Fig. 9

The 3/4" spacer (N) may be used by itself (Fig. 7), or in combination with the 5/8" spacer (M), for even greater depth. Stack the two spacers (Fig. 8), and then install them between the display and the mounting rail. (Fig. 9)